

**This electronic collection of documents is provided
for the convenience of the user
and is Not a Certified Document –**

**The documents contained herein were originally issued
and sealed by the individuals whose names and license
numbers appear on each page, on the dates appearing
with their signature on that page.**

**This file or an individual page
shall not be considered a certified document.**

WARREN COUNTY

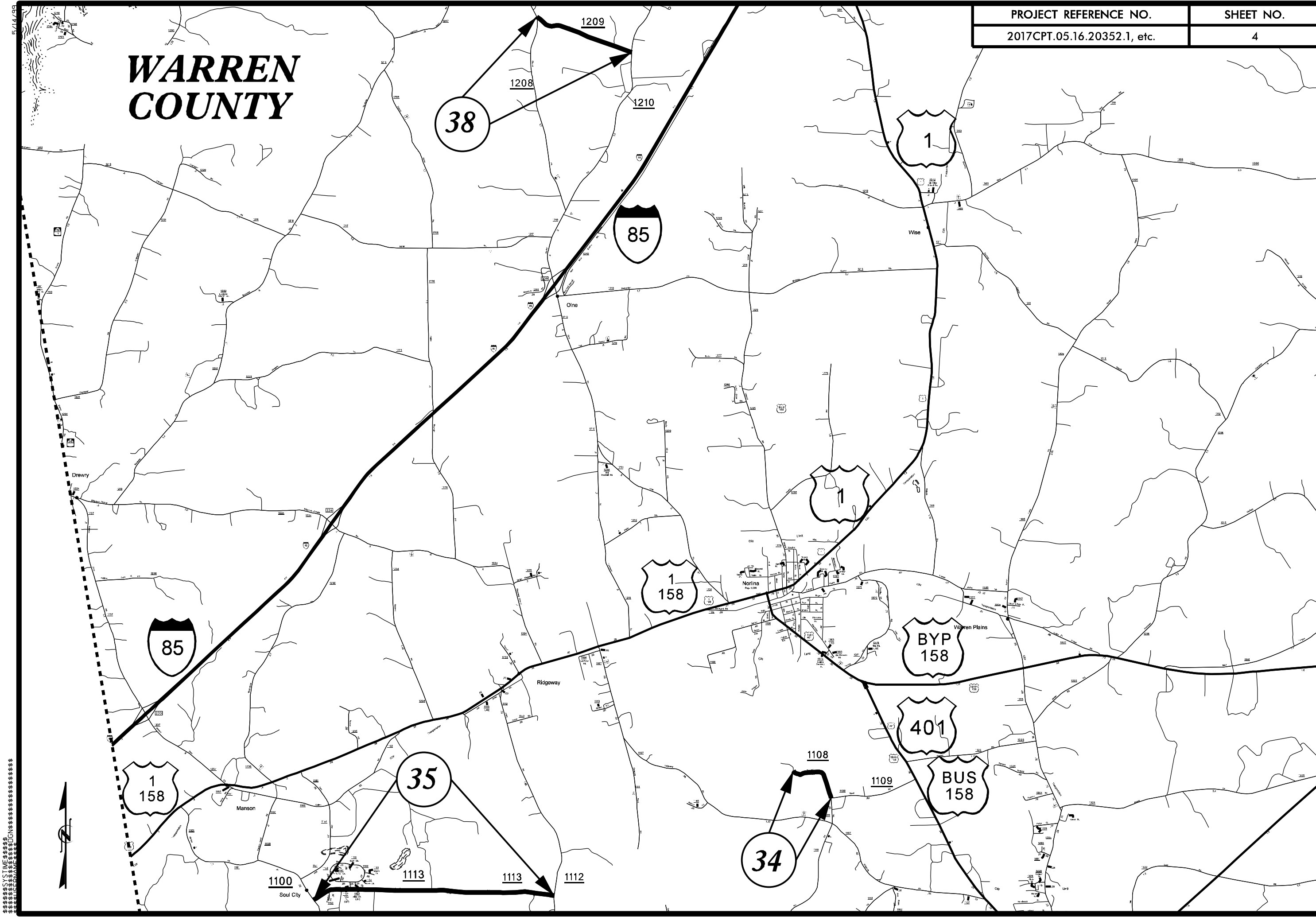

5/14/19
C:\PROJECTS\2017CPT\2017CPT.05.16.20352.1\DRAWINGS\WARREN\WARREN.MXD

PAVEMENT SCHEDULE

F	PROP. ASPHALT SURFACE TREATMENT, DOUBLE SEAL
U	EXISTING PAVEMENT

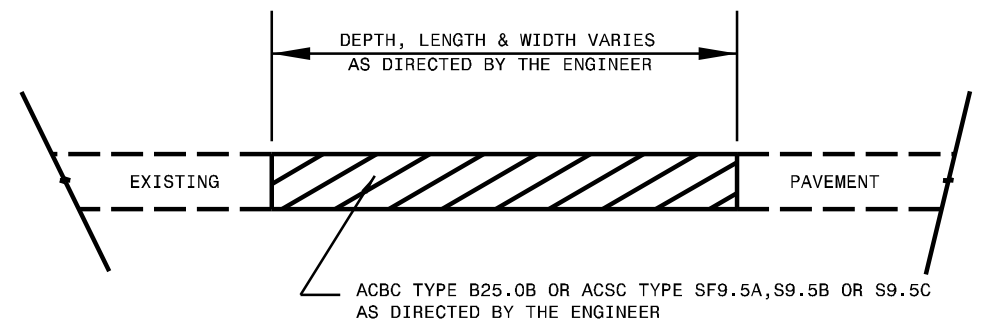

PATCHING EXISTING PAVEMENT
MILLING (IF REQUIRED BY TYPICAL) TO BE PERFORMED PRIOR TO PATCHING

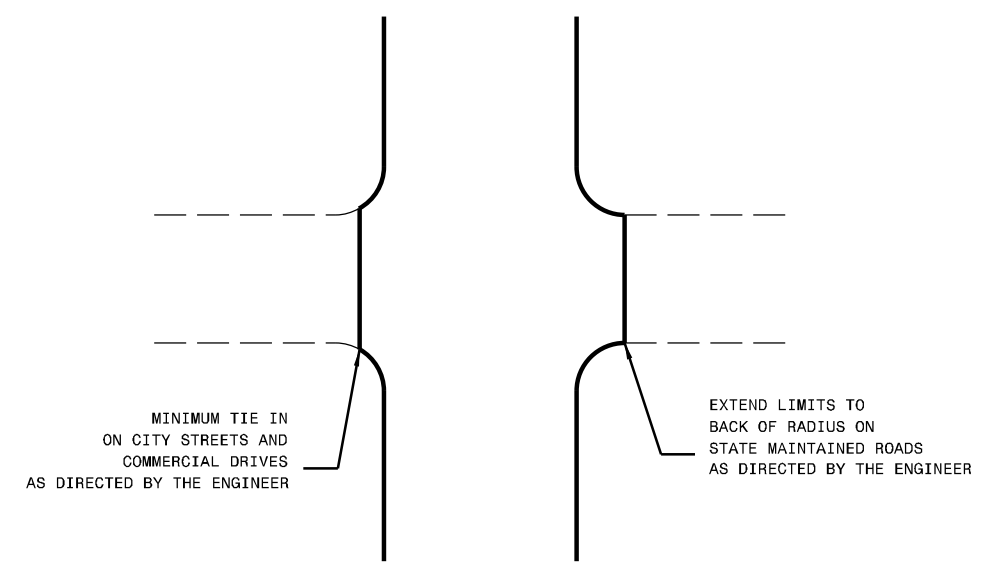

DETAIL OF PROJECT LIMITS AT Y LINES

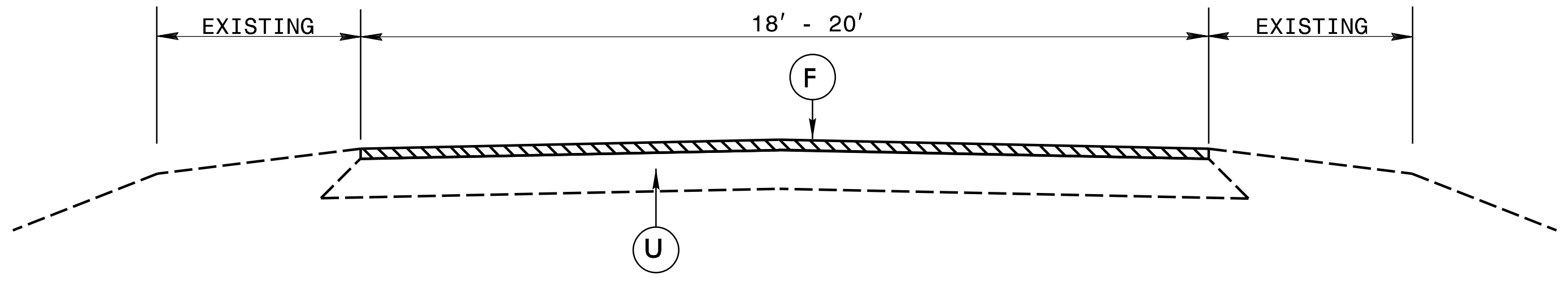

TYPICAL SECTION 1

PROJECT NO.	SHEET NO.	TOTAL NO.
2017CPT.05.16.20352.1, etc.		

SUMMARY OF QUANTITIES

PROJECT NO	COUNTY	MAP NO	ROUTE	DESCRIPTION	TYP	LANES	LANE TYPE	FINAL SURFACE TESTING REQUIRED	WARMMX ASPHALT REQUIRED	LENGTH M	WIDTH FT	PATCHING EXISTING PAVEMENT TONS	ASPHALT SURFACE TREATMENT, DOUBLE SEAL SY	EMULSION FOR ASPHALT SURFACE TREATMENT GAL
2017CPT.05.16.20352.1	Franklin	1	SR 1412 - PETE SMITH RD	SR 1407 TO SR 1401	1	2		NO	NO	2.02	20	51	23,701	13,036
TOTAL FOR MAP NO. 1														
2017CPT.05.16.20352.1	Franklin	2	SR 1415 - MOULTON WAY	SR 1414 TO SR 1002	1	2		NO	NO	0.26	20	7	3,051	1,678
TOTAL FOR MAP NO. 2														
2017CPT.05.16.20352.1	Franklin	3	SR 1423 - MASSENBERG BAKER RD	SR 1421 TO END OF PAVEMENT	1	2		NO	NO	1.42	20	36	16,661	9,164
TOTAL FOR MAP NO. 3														
2017CPT.05.16.20352.1	Franklin	4	SR 1424 - WHELESS RD	NC 56 TO SR 1423	1	2		NO	NO	1.5	20	38	17,600	9,680
TOTAL FOR MAP NO. 4														
2017CPT.05.16.20352.1	Franklin	5	SR 1431 - LESTER RD	NC 561 TO SR 1430	1	2		NO	NO	0.13	18	4	1,373	755
TOTAL FOR MAP NO. 5														
2017CPT.05.16.20352.1	Franklin	6	SR 1445 - THOMAS JONES RD	SR 1446 TO END OF PAVEMENT	1	2		NO	NO	1.4	20	35	16,427	9,035
TOTAL FOR MAP NO. 6														
2017CPT.05.16.20352.1	Franklin	7	SR 1446 - WOOD CHURCH RD	NC 561 TO NC 561	1	2		NO	NO	1.55	18	39	16,368	9,003
TOTAL FOR MAP NO. 7														
2017CPT.05.16.20352.1	Franklin	8	SR 1448 - MT HEBRON RD	SR 1449 TO NASH COUNTY	1	2		NO	NO	1.69	18	43	17,846	9,815
TOTAL FOR MAP NO. 8														
2017CPT.05.16.20352.1	Franklin	9	SR 1450 - REED RD	SR 1448 TO SR 1449	1	2		NO	NO	2.58	20	65	30,272	16,650
TOTAL FOR MAP NO. 9														
2017CPT.05.16.20352.1	Franklin	10	SR 1455 - BARTHOLOMEW RD	SR 1425 TO SR 1454	1	2		NO	NO	0.55	20	14	6,453	3,550
TOTAL FOR MAP NO. 10														
2017CPT.05.16.20352.1	Franklin	11	SR 1458 - BREWER RD	SR 1425 TO SR 1457	1	2		NO	NO	1.14	20	29	13,376	7,357
TOTAL FOR MAP NO. 11														
2017CPT.05.16.20352.1	Franklin	12	SR 1459 - WOOD RD	SR 1457 TO SR 1425	1	2		NO	NO	1.07	18	27	11,299	6,215
TOTAL FOR MAP NO. 12														
2017CPT.05.16.20352.1	Franklin	13	SR 1460 - J B LEONARD RD	SR 1457 TO SR 1449	1	2		NO	NO	1.14	20	29	13,376	7,357
TOTAL FOR MAP NO. 13														
2017CPT.05.16.20352.1	Franklin	14	SR 1463 - RED BUD CHURCH RD	NC 58 TO END OF PAVEMENT	1	2		NO	NO	0.52	20	13	6,101	3,356
TOTAL FOR MAP NO. 14														
2017CPT.05.16.20352.1	Franklin	15	SR 1465 - KING RD	SR 1425 TO CUL-DE-SAC	1	2		NO	NO	0.83	20	21	9,739	5,357
TOTAL FOR MAP NO. 15														
2017CPT.05.16.20352.1	Franklin	16	SR 1468 - WALTER COLLINS RD	SR 1425 TO NC 56	1	2		NO	NO	2.46	18	62	25,978	14,288
TOTAL FOR MAP NO. 16														
2017CPT.05.16.20352.1	Franklin	17	SR 1469 - EARLIE COLLINS RD	SR 1474 TO SR 1467	1	2		NO	NO	1.84	20	46	21,589	11,874
TOTAL FOR MAP NO. 17														
2017CPT.05.16.20352.1	Franklin	18	SR 1473 - REYNOLDS RD	NC 561 TO END OF PAVEMENT	1	2		NO	NO	1.41	20	35	16,544	9,099
TOTAL FOR MAP NO. 18														
2017CPT.05.16.20352.1	Franklin	19	SR 1491 - MOOSE LOOP RD	NC 56 TO NC 56	1	2		NO	NO	0.48	18	12	5,069	2,788
TOTAL FOR MAP NO. 19														
2017CPT.05.16.20352.1	Franklin	20	SR 1641 - HILLARD RD	NC 56 TO CUL-DE-SAC	1	2		NO	NO	0.38	20	10	4,459	2,453
TOTAL FOR MAP NO. 20														
TOTAL FOR PROJ NO. 2017CPT.05.16.20352.1														
2017CPT.05.16.20912.1	Vance	21	SR 1101 - CHARLIE GRISSOM RD	FRANKLIN CO TO SR 1107	1	2		NO	NO	7.91	20		92,811	51,046
TOTAL FOR MAP NO. 21														
2017CPT.05.16.20912.1	Vance	22	SR 1102 - WILTON RD	SR 1101 TO GRANVILLE COUNTY	1	2		NO	NO	0.21	20		2,464	1,355
TOTAL FOR MAP NO. 22														
2017CPT.05.16.20912.1	Vance	23	SR 1104 - BEECHTREE TRL	SR 1555 TO END OF PAVEMENT	1	2		NO	NO	1.25	20		14,667	8,067
TOTAL FOR MAP NO. 23														

										PROJECT NO.	SHEET NO.	TOTAL NO.	
										2017CPT.05.16.20352.1, etc.			
2017CPT.05.16.20912.1	Vance	24	SR 1109 - B L HARRIS RD	SR 1107 TO END OF MAINT.	1	2		NO	NO	0.54	20	6,336	3,485
TOTAL FOR MAP NO. 24										0.54		6,336	3,485
2017CPT.05.16.20912.1	Vance	25	SR 1111 - WRENN RD	SR 1110 TO GRANVILLE COUNTY	1	2		NO	NO	0.3	20	3,520	1,936
TOTAL FOR MAP NO. 25										0.3		3,520	1,936
2017CPT.05.16.20912.1	Vance	26	SR 1112 - DAVIS RD	SR 1101 TO CUL-DE-SAC	1	2		NO	NO	0.67	20	7,861	4,324
TOTAL FOR MAP NO. 26										0.67		7,861	4,324
2017CPT.05.16.20912.1	Vance	27	SR 1116 - LEON FRAIZER RD	SR 1115 TO CUL-DE-SAC	1	2		NO	NO	0.61	20	7,157	3,937
TOTAL FOR MAP NO. 27										0.61		7,157	3,937
2017CPT.05.16.20912.1	Vance	28	SR 1122 - MATTHEWS RD	US 158 BUS TO SR 1121	1	2		NO	NO	2.2	20	25,813	14,197
TOTAL FOR MAP NO. 28										2.2		25,813	14,197
2017CPT.05.16.20912.1	Vance	29	SR 1240 - KITTRELL VANCE AVE	US1 TO END OF MAINT.	1	2		NO	NO	0.24	20	2,816	1,549
TOTAL FOR MAP NO. 29										0.24		2,816	1,549
2017CPT.05.16.20912.1	Vance	30	SR 1254 - DIXIE DR	SR 1240 TO END OF MAINT.	1	2		NO	NO	0.2	20	2,347	1,291
TOTAL FOR MAP NO. 30										0.2		2,347	1,291
2017CPT.05.16.20912.1	Vance	31	SR 1262 - LYNNBANK ESTATES RD	SR 1101 TO SR 1101	1	2		NO	NO	0.48	20	5,632	3,098
TOTAL FOR MAP NO. 31										0.48		5,632	3,098
2017CPT.05.16.20912.1	Vance	32	SR 1268 - PULLEYVILLE RD	US 1 TO END OF MAINT.	1	2		NO	NO	0.17	20	1,995	1,098
TOTAL FOR MAP NO. 32										0.17		1,995	1,098
2017CPT.05.16.20912.1	Vance	33	SR 1280 - COUNTRY ACRES RD	SR 1101 TO DEAD END	1	2		NO	NO	0.54	20	6,336	3,485
TOTAL FOR MAP NO. 33										0.54		6,336	3,485
TOTAL FOR PROJ NO. 2017CPT.05.16.20912.1										15.32		179,755	98,868
2017CPT.05.16.20932.1	Warren	34	SR 1108 - TUNSTALL RD/FOGG LN	SR 1109 TO DEAD END	1	2		NO	NO	0.51	20	5,984	3,291
TOTAL FOR MAP NO. 34										0.51		5,984	3,291
2017CPT.05.16.20932.1	Warren	35	SR 1113 - LIBERATION RD	SR 1112 TO SR 1100	1	2		NO	NO	2.13	20	24,992	13,746
TOTAL FOR MAP NO. 35										2.13		24,992	13,746
2017CPT.05.16.20932.1	Warren	36	SR 1122 - FULLER RD	SR 1116 TO US 401	1	2		NO	NO	0.1	20	1,173	646
TOTAL FOR MAP NO. 36										0.1		1,173	646
2017CPT.05.16.20932.1	Warren	37	SR 1126 - CROSS CREEK RD	SR 1134 TO VANCE COUNTY	1	2		NO	NO	0.57	20	6,688	3,679
TOTAL FOR MAP NO. 37										0.57		6,688	3,679
2017CPT.05.16.20932.1	Warren	38	SR 1209 - HARRISON RD	SR 1208 TO SR 1210	1	2		NO	NO	0.9	20	10,560	5,808
TOTAL FOR MAP NO. 38										0.9		10,560	5,808
2017CPT.05.16.20932.1	Warren	39	SR 1349 - BOBBITT RD	US 158 TO CUL-DE-SAC	1	2		NO	NO	0.86	20	10,091	5,550
TOTAL FOR MAP NO. 39										0.86		10,091	5,550
2017CPT.05.16.20932.1	Warren	40	SR 1370 - N MAIN ST	HALIFAX COUNTY TO END OF MAINT.	1	2		NO	NO	0.3	20	3,520	1,936
TOTAL FOR MAP NO. 40										0.3		3,520	1,936
2017CPT.05.16.20932.1	Warren	41	SR 1505 - DENNIS HARRIS RD	SR 1507 TO US 158	1	2		NO	NO	1.48	20	17,365	9,551
TOTAL FOR MAP NO. 41										1.48		17,365	9,551
2017CPT.05.16.20932.1	Warren	42	SR 1512 - DAVIS BUGG RD/REEDY CR RD	NC 58 TO SR 1515	1	2		NO	NO	6.8	20	79,787	43,883
TOTAL FOR MAP NO. 42										6.8		79,787	43,883
2017CPT.05.16.20932.1	Warren	43	SR 1526 - PANACEA SPRINGS RD	SR 1509 TO HALIFAC COUNTY	1	2		NO	NO	2.16	20	25,344	13,939
TOTAL FOR MAP NO. 43										2.16		25,344	13,939
2017CPT.05.16.20932.1	Warren	44	SR 1613 - SHOCCO SPRINGS RD	SR 1625 TO SR 1620	1	2		NO	NO	4.43	20	51,979	28,589
TOTAL FOR MAP NO. 44										4.43		51,979	28,589
TOTAL FOR PROJ NO. 2017CPT.05.16.20932.1										20.24		237,483	130,618
GRAND TOTAL										59.93	616	694,520	381,996

PROJECT NO.	SHEET NO.	TOTAL NO.
2017CPT.05.16.20352.1, etc.		

THERMOPLASTIC AND PAINT QUANTITIES

PROJECT NO	COUNTY	MAP NO	ROUTE	DESCRIPTION	TYP	LANES	LANE TYPE	LENGTH	WIDTH	4413000000-E	4457000000-N	4890000000-E
										WDRK ZONE ADVANCE/GENERAL WARNING SIGNING	TEMPORARY TRAFFIC CONTROL	HOT SPRAY THERMOPLASTIC PAVEMENT MARKING LINES, 4", 40 ML LF
										SF	LS	ML LF
2017CPT.05.16.20352.1	Franklin	1	SR 1412 - PETE SMITH RD	SR 1407 TO SR 1401	1	2		2.02	20	227	0.03	39,970
TOTAL FOR MAP NO. 1										227	0.03	39,970
2017CPT.05.16.20352.1	Franklin	2	SR 1415 - MOULTON WAY	SR 1414 TO SR 1002	1	2		0.26	20	30	0.01	4,072
TOTAL FOR MAP NO. 2										30	0.01	4,072
2017CPT.05.16.20352.1	Franklin	3	SR 1423 - MASSENBERG BAKER RD	SR 1421 TO END OF PAVEMENT	1	2		1.42	20	160	0.02	29,848
TOTAL FOR MAP NO. 3										160	0.02	29,848
2017CPT.05.16.20352.1	Franklin	4	SR 1424 - WHELESS RD	NC 56 TO SR 1423	1	2		1.5	20	168	0.02	29,764
TOTAL FOR MAP NO. 4										168	0.02	29,764
2017CPT.05.16.20352.1	Franklin	5	SR 1431 - LESTER RD	NC 561 TO SR 1430	1	2		0.13	18	15	0.01	2,530
TOTAL FOR MAP NO. 5										15	0.01	2,530
2017CPT.05.16.20352.1	Franklin	6	SR 1445 - THOMAS JONES RD	SR 1446 TO END OF PAVEMENT	1	2		1.4	20	220	0.02	29,568
TOTAL FOR MAP NO. 6										220	0.02	29,568
2017CPT.05.16.20352.1	Franklin	7	SR 1446 - WOOD CHURCH RD	NC 561 TO NC 561	1	2		1.55	18	174	0.02	30,460
TOTAL FOR MAP NO. 7										174	0.02	30,460
2017CPT.05.16.20352.1	Franklin	8	SR 1448 - MT HEBRON RD	SR 1449 TO NASH COUNTY	1	2		1.69	18	190	0.02	30,408
TOTAL FOR MAP NO. 8										190	0.02	30,408
2017CPT.05.16.20352.1	Franklin	9	SR 1450 - REED RD	SR 1448 TO SR 1449	1	2		2.58	20	289	0.04	52,032
TOTAL FOR MAP NO. 9										289	0.04	52,032
2017CPT.05.16.20352.1	Franklin	10	SR 1455 - BARTHOLOMEW RD	SR 1425 TO SR 1454	1	2		0.55	20	62	0.01	11,500
TOTAL FOR MAP NO. 10										62	0.01	11,500
2017CPT.05.16.20352.1	Franklin	11	SR 1458 - BREWER RD	SR 1425 TO SR 1457	1	2		1.14	20	128	0.02	19,735
TOTAL FOR MAP NO. 11										128	0.02	19,735
2017CPT.05.16.20352.1	Franklin	12	SR 1459 - WOOD RD	SR 1457 TO SR 1425	1	2		1.07	18	120	0.02	20,770
TOTAL FOR MAP NO. 12										120	0.02	20,770
2017CPT.05.16.20352.1	Franklin	13	SR 1460 - J B LEONARD RD	SR 1457 TO SR 1449	1	2		1.14	20	128	0.02	23,383
TOTAL FOR MAP NO. 13										128	0.02	23,383
2017CPT.05.16.20352.1	Franklin	14	SR 1463 - RED BUD CHURCH RD	NC 58 TO END OF PAVEMENT	1	2		0.52	20	59	0.01	
TOTAL FOR MAP NO. 14										59	0.01	
2017CPT.05.16.20352.1	Franklin	15	SR 1465 - KING RD	SR 1425 TO CUL-DE-SAC	1	2		0.83	20	93	0.01	
TOTAL FOR MAP NO. 15										93	0.01	
2017CPT.05.16.20352.1	Franklin	16	SR 1468 - WALTER COLLINS RD	SR 1425 TO NC 56	1	2		2.46	18	276	0.04	51,440
TOTAL FOR MAP NO. 16										276	0.04	51,440
2017CPT.05.16.20352.1	Franklin	17	SR 1469 - EARLIE COLLINS RD	SR 1474 TO SR 1467	1	2		1.84	20	207	0.03	38,464
TOTAL FOR MAP NO. 17										207	0.03	38,464
2017CPT.05.16.20352.1	Franklin	18	SR 1473 - REYNOLDS RD	NC 561 TO END OF PAVEMENT	1	2		1.41	20	158	0.02	25,720
TOTAL FOR MAP NO. 18										158	0.02	25,720
2017CPT.05.16.20352.1	Franklin	19	SR 1491 - MOOSE LOOP RD	NC 56 TO NC 56	1	2		0.48	18	54	0.01	
TOTAL FOR MAP NO. 19										54	0.01	
2017CPT.05.16.20352.1	Franklin	20	SR 1641 - HILLARD RD	NC 56 TO CUL-DE-SAC	1	2		0.38	20	43	0.01	
TOTAL FOR MAP NO. 20										43	0.01	
TOTAL FOR PROJ NO. 2017CPT.05.16.20352.1										2,801	0.39	439,664
2017CPT.05.16.20912.1	Vance	21	SR 1101 - CHARLIE GRISSOM RD	FRANKLIN CO TO SR 1107	1	2		7.91	20	886	0.11	11,867
TOTAL FOR MAP NO. 21										886	0.11	11,867
2017CPT.05.16.20912.1	Vance	22	SR 1102 - WILTON RD	SR 1101 TO GRANVILLE COUNTY	1	2		0.21	20	24	0.01	4,464

								PROJECT NO.	SHEET NO.	TOTAL NO.	
								2017CPT.05.16.20352.1, etc.			
TOTAL FOR MAP NO. 22								0.21	24	0.01	4,464
2017CPT.05.16.20912.1	Vance	23	SR 1104 - BEECHTREE TRL	SR 1555 TO END OF PAVEMENT	1	2	1.25	20	140	0.02	26,400
TOTAL FOR MAP NO. 23								1.25	140	0.02	26,400
2017CPT.05.16.20912.1	Vance	24	SR 1109 - B L HARRIS RD	SR 1107 TO END OF MAINT.	1	2	0.54	20	61	0.01	
TOTAL FOR MAP NO. 24								0.54	61	0.01	
2017CPT.05.16.20912.1	Vance	25	SR 1111 - WRENN RD	SR 1110 TO GRANVILLE COUNTY	1	2	0.3	20	34	0.01	6,312
TOTAL FOR MAP NO. 25								0.3	34	0.01	6,312
2017CPT.05.16.20912.1	Vance	26	SR 1112 - DAVIS RD	SR 1101 TO CUL-DE-SAC	1	2	0.67	20	76	0.01	
TOTAL FOR MAP NO. 26								0.67	76	0.01	
2017CPT.05.16.20912.1	Vance	27	SR 1116 - LEON FRAIZER RD	SR 1115 TO CUL-DE-SAC	1	2	0.61	20	69	0.01	
TOTAL FOR MAP NO. 27								0.61	69	0.01	
2017CPT.05.16.20912.1	Vance	28	SR 1122 - MATTHEWS RD	US 158 BUS TO SR 1121	1	2	2.2	20	247	0.03	46,464
TOTAL FOR MAP NO. 28								2.2	247	0.03	46,464
2017CPT.05.16.20912.1	Vance	29	SR 1240 - KITTRELL VANCE AVE	US1 TO END OF MAINT.	1	2	0.24	20	27	0.01	620
TOTAL FOR MAP NO. 29								0.24	27	0.01	620
2017CPT.05.16.20912.1	Vance	30	SR 1254 - DIXIE DR	SR 1240 TO END OF MAINT.	1	2	0.2	20	23	0.01	
TOTAL FOR MAP NO. 30								0.2	23	0.01	
2017CPT.05.16.20912.1	Vance	31	SR 1262 - LYNNBANK ESTATES RD	SR 1101 TO SR 1101	1	2	0.48	20	54	0.01	
TOTAL FOR MAP NO. 31								0.48	54	0.01	
2017CPT.05.16.20912.1	Vance	32	SR 1268 - PULLEYVILLE RD	US 1 TO END OF MAINT.	1	2	0.17	20	20	0.01	1,280
TOTAL FOR MAP NO. 32								0.17	20	0.01	1,280
2017CPT.05.16.20912.1	Vance	33	SR 1280 - COUNTRY ACRES RD	SR 1101 TO DEAD END	1	2	0.54	20	61	0.01	
TOTAL FOR MAP NO. 33								0.54	61	0.01	
TOTAL FOR PROJ NO. 2017CPT.05.16.20912.1								15.32	1,722	0.26	97,407
2017CPT.05.16.20932.1	Warren	34	SR 1108 - TUNSTALL RD/FOGG LN	SR 1109 TO DEAD END	1	2	0.51	20	58	0.01	
TOTAL FOR MAP NO. 34								0.51	58	0.01	
2017CPT.05.16.20932.1	Warren	35	SR 1113 - LIBERATION RD	SR 1112 TO SR 1100	1	2	2.13	20	239	0.04	40,132
TOTAL FOR MAP NO. 35								2.13	239	0.04	40,132
2017CPT.05.16.20932.1	Warren	36	SR 1122 - FULLER RD	SR 1116 TO US 401	1	2	0.1	20	12	0.01	2,000
TOTAL FOR MAP NO. 36								0.1	12	0.01	2,000
2017CPT.05.16.20932.1	Warren	37	SR 1126 - CROSS CREEK RD	SR 1134 TO VANCE COUNTY	1	2	0.57	20	64	0.01	11,292
TOTAL FOR MAP NO. 37								0.57	64	0.01	11,292
2017CPT.05.16.20932.1	Warren	38	SR 1209 - HARRISON RD	SR 1208 TO SR 1210	1	2	0.9	20	101	0.01	
TOTAL FOR MAP NO. 38								0.9	101	0.01	
2017CPT.05.16.20932.1	Warren	39	SR 1349 - BOBBITT RD	US 158 TO CUL-DE-SAC	1	2	0.86	20	97	0.01	
TOTAL FOR MAP NO. 39								0.86	97	0.01	
2017CPT.05.16.20932.1	Warren	40	SR 1370 - N MAIN ST	HALIFAX COUNTY TO END OF MAINT.	1	2	0.3	20	34	0.01	
TOTAL FOR MAP NO. 40								0.3	34	0.01	
2017CPT.05.16.20932.1	Warren	41	SR 1505 - DENNIS HARRIS RD	SR 1507 TO US 158	1	2	1.48	20	166	0.02	29,378
TOTAL FOR MAP NO. 41								1.48	166	0.02	29,378
2017CPT.05.16.20932.1	Warren	42	SR 1512 - DAVIS BUGG RD/REEDY CR RD	NC 58 TO SR 1515	1	2	6.8	20	762	0.12	139,605
TOTAL FOR MAP NO. 42								6.8	762	0.12	139,605
2017CPT.05.16.20932.1	Warren	43	SR 1526 - PANACEA SPRINGS RD	SR 1509 TO HALIFAC COUNTY	1	2	2.16	20	242	0.03	43,610
TOTAL FOR MAP NO. 43								2.16	242	0.03	43,610
2017CPT.05.16.20932.1	Warren	44	SR 1613 - SHOCCO SPRINGS RD	SR 1625 TO SR 1620	1	2	4.43	20	497	0.08	93,136
TOTAL FOR MAP NO. 44								4.43	497	0.08	93,136
TOTAL FOR PROJ NO. 2017CPT.05.16.20932.1								20.24	2,272	0.35	359,153

SIGNING FOR RESURFACING PROJECTS

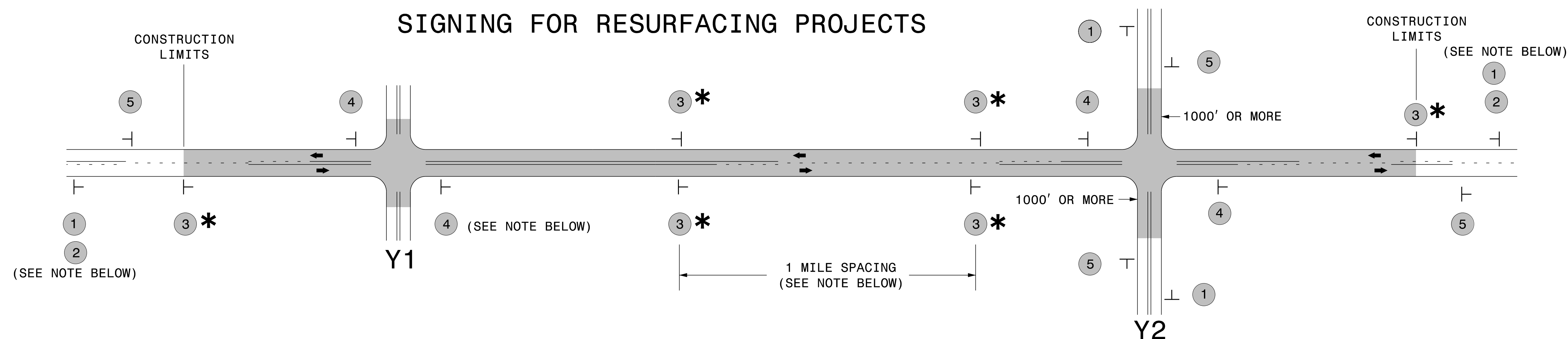

LEGEND	
	STATIONARY SIGN
←	DIRECTION OF TRAFFIC FLOW

MAINLINE (-L-) SIGNING

-Y- LINE SIGNING

SIGNING NOTES AND PLACEMENT PER DIRECTION	1	 <small>W20-1 48" X 48"</small>	PLACE 1000' PRIOR TO BEGINNING OF CONSTRUCTION LIMITS. ONLY USED ON -Y- LINES IF RESURFACING LIMITS EXTEND 1000' ALONG -Y- LINE.	<p style="text-align: center;">NO REQUIRED STATIONARY SIGNING FOR THE FOLLOWING -Y- LINE CONDITIONS:</p> <ol style="list-style-type: none"> 1) LESS THAN 1000' OF RESURFACING ALONG -Y- LINE 2) SUBDIVISION ROADS 3) DEAD END ROADS <p style="text-align: center;">WHEN PAVING/CONSTRUCTION ACTIVITIES PROCEED ACROSS AN UNSIGNED -Y- LINE, ADVANCE WARNING PORTABLE SIGNS SHALL BE USED ALONG THE -Y- LINE AS SHOWN BELOW. REMOVE UPON COMPLETION OF WORK.</p> <div style="display: flex; justify-content: space-around; align-items: center;"> <div style="text-align: center;"> <small>W20-1 48" X 48"</small> </div> <div style="text-align: center;"> <small>W20-7 A 48" X 48"</small> </div> </div> <p style="text-align: center;">PLACED 500' IN ADVANCE OF FLAGGER. PLACED 250' IN ADVANCE OF FLAGGER.</p>
	2	 <small>W7-3aP 24" X 18"</small>	#2 SIGN ONLY USED WHEN RESURFACING LIMITS ARE 2 OR MORE MILES IN LENGTH. ROUND UP TO NEXT WHOLE NUMBER. (NO FRACTIONAL OR DECIMAL NUMBERS)	
	3 *	 <small>SP 13107 48" X 48"</small>	PLACE INITIALLY AT THE CONSTRUCTION LIMITS AND SPACED 1 MILE APART THEREAFTER. IF NO -Y- LINES EXIST, PLACE 2ND SET 1/2 MILE FROM THE CONSTRUCTION LIMITS AND THEN SPACE 1 MILE THEREAFTER.	
	4	 <small>SP 13106 48" X 48"</small>	THESE ARE FOR -Y- LINES THAT ARE "THROUGH" ROADWAYS. DEAD END AND SUBDIVISION ROADS ARE NOT "THROUGH" ROADWAYS. INSTALL 500' +/- FROM EACH -Y- LINE APPROACH AS SHOWN ABOVE. FOR MULTIPLE -Y- LINES THAT ARE SEPARATED BY 0.25 MILES OR LESS, TREAT AS A SINGLE UNIT AND INSTALL WITHIN 500' OF EACH APPROACH. A MAXIMUM OF 2 SIGN SETS PER MILE. DO NOT INSTALL WHEN -Y- LINES ARE WITHIN 0.5 MILES FROM "END ROAD WORK" SIGN.	
5	 <small>G20-2 A 48" X 24"</small>	PLACE 500' FOLLOWING THE END OF CONSTRUCTION LIMITS.		

* SIGNING FOR ASPHALT SURFACE TREATMENTS (ONLY)

SUBSTITUTE LOW/SOFT SHOULDER SIGNS BY ALTERNATING THE FOLLOWING TWO SIGNS:
 STARTING WITH "UNMARKED PAVEMENT AHEAD" (SP 06026) FOLLOWED BY "LOOSE GRAVEL" (W8-7).



**RESURFACING
ADVANCE WARNING SIGNS
FOR
RURAL AND SUBURBAN
2 LANE ROADWAYS**